

p2600.2 2600-2600-009C / Drive & Differential

ILLUSTRATION SHOWS TYPICAL PARTS ONLY. ORDER BY PART NUMBER. PARTS NOT LISTED ARE SUPPLIED BY OEM.

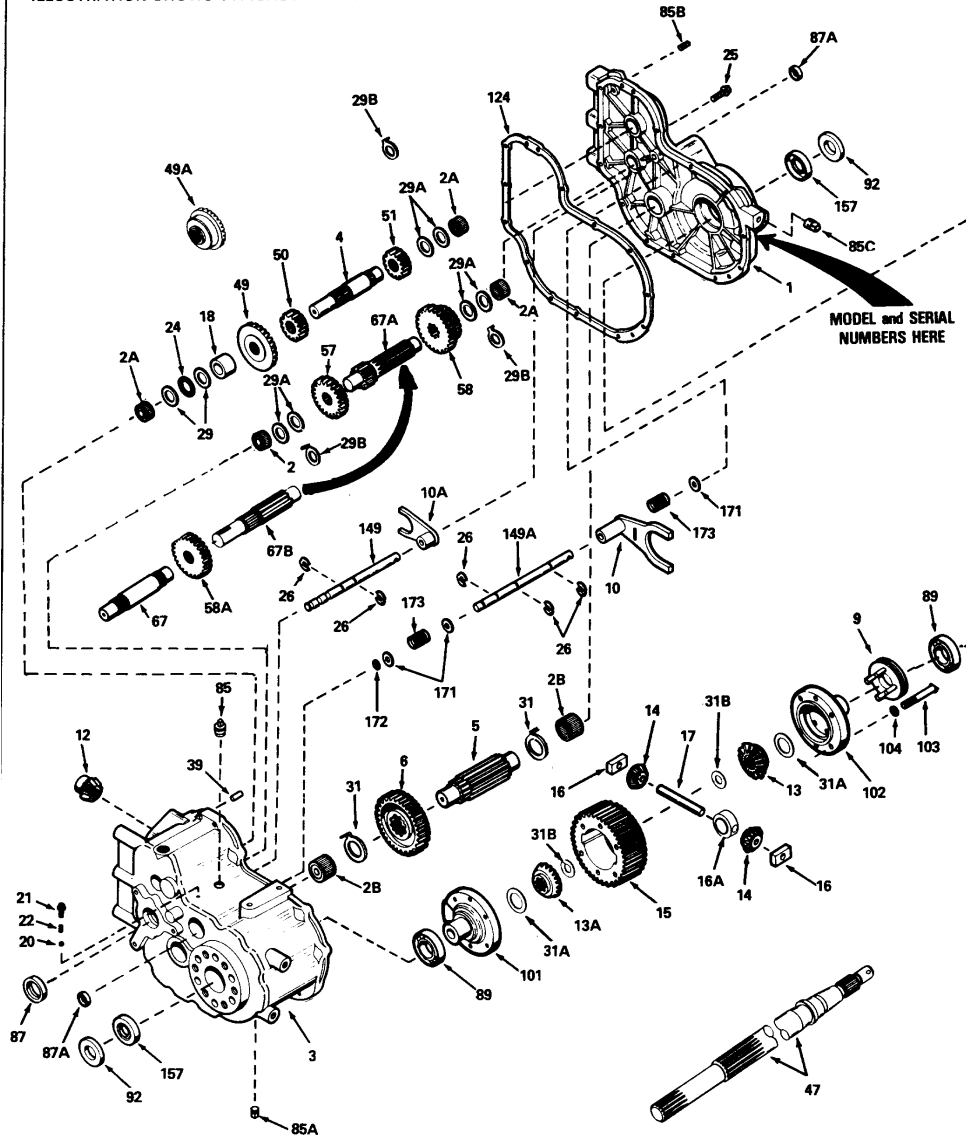

Part List

p2600.2 2600-2600-009C / Drive & Differential

REF #	ITEM #	DESCRIPTION	QTY	REMARK
1	772086	Transaxle Cover (Incl. 2A & 2B)	1	
2	780097	Needle Bearing 1.000 ID	1	
2A	780100	Needle Bearing 1.250 ID	3	
2B	780099	Needle Bearing 1.000 ID	2	
3	770086A	Transaxle Case (Incl. 2, 2A & 2B)	1	
4	776209A	Countershaft	1	
5	776120A	Output Pinion (13 teeth)	1	
6	778103	Output Gear (33 teeth)	1	
9	784325A	Shift Collar	1	
10	784328	Shift Fork	1	
10A	784195	Shift Fork	1	
12	778155	Bevel Pinion (Loose Part)	1	
13	778159	Bevel Gear	1	
13A	778158	Bevel Gear	1	
14	778157	Bevel Pinion	2	
15	778156	Ring Gear	1	
16	786098	Drive Block	2	
17	786096	Drive Pin	1	
18	786094	Spacer	1	
20	792004	Steel Ball, 3/16" dia.	1	
21	792100	Screw, 1/4-20 x 5/8"	1	
22	792003	Shift Fork Spring	1	
24	780012	Thrust Bearing	1	
26	792064	Retaining Ring	5	
29	780045	Thrust Washer	2	
29B	780157	Thrust Washer	3	
31	780156	Thrust Washer	2	
31A	780130	Thrust Washer	1	
39	786026	Dowel Pin	2	
49	778087	Bevel Gear (30 teeth-steel)	1	
50	778088	Spur Gear (16 teeth-steel)	1	
51	778096	Spur Gear (23 teeth-steel)	1	
57	778102	Spur Gear (17 teeth-steel)	1	
58	778097	Cluster Gear (20 & 27 teeth)	1	
67B	776119	Brake Shaft (splined)	1	
85A	792019	Magnetic Drain Plug, 3/8-18	1	
85B	792039	Pipe Plug, 1/8-27	2	
87	788008	Oil Seal 1"	1	
87A	788034	Oil Seal 1/2"	2	
89	780125	Ball Bearing 1.5743 ID	2	
92	786097	Spacer 1.160 x .365 (Loose Part)	1	
101	774486A	Differential Carrier (Incl. 31A)	1	
102	774487	Differential Carrier	1	
103	792101	Screw, 3/8-16 x 2-3/4"	6	
104	792011	Lockwasher, 3/8"	6	
124	788058B	Case-to-Cover Gasket	1	
149	784326A	Shift Rod (Hi-Low)	1	
149A	784327A	Shift Rod (Differential Lock)	1	
157	788049	Oil Seal 1-1/8"	2	
171	780070	Thrust Washer	3	
172	792099	Retaining Ring	1	
173	792102	Compression Spring	2	
204A	792067	Screw, 5/16-18 x 1"	13	